

# BROADVIEW MATERIALS

Arpa 

FENIX®

FORMICA®

GETACORE®

HOMAPAL

TRESPA®

WESTAG 

WORKTOP  
EXPRESS



# BROADVIEW MATERIALS

A WIDE OFFER OF BRANDS, PRODUCTS AND SOLUTIONS

Broadview Materials is a global group of leading brands in surface materials. We help you materialize designs that stand out in quality, beauty and sustainability, while remaining affordable.

We have a strong heritage and some of our companies and brands have been shaping their industries for over a century, consistently leading and innovating their markets and categories. We bring together a wide range of well-known brands like Formica®, FENIX®, Arpa®, Homapal®, Getacore®, Trespa®, Westag® and Worktop Express®.

Broadview Materials is here to help you to materialize your potential.

**Together we stand out.**

Arpa 

FENIX®

 FORMICA®

GETACORE®

 HOMAPAL

TRES|SPA®

WESTAG 

 WORKTOP  
EXPRESS

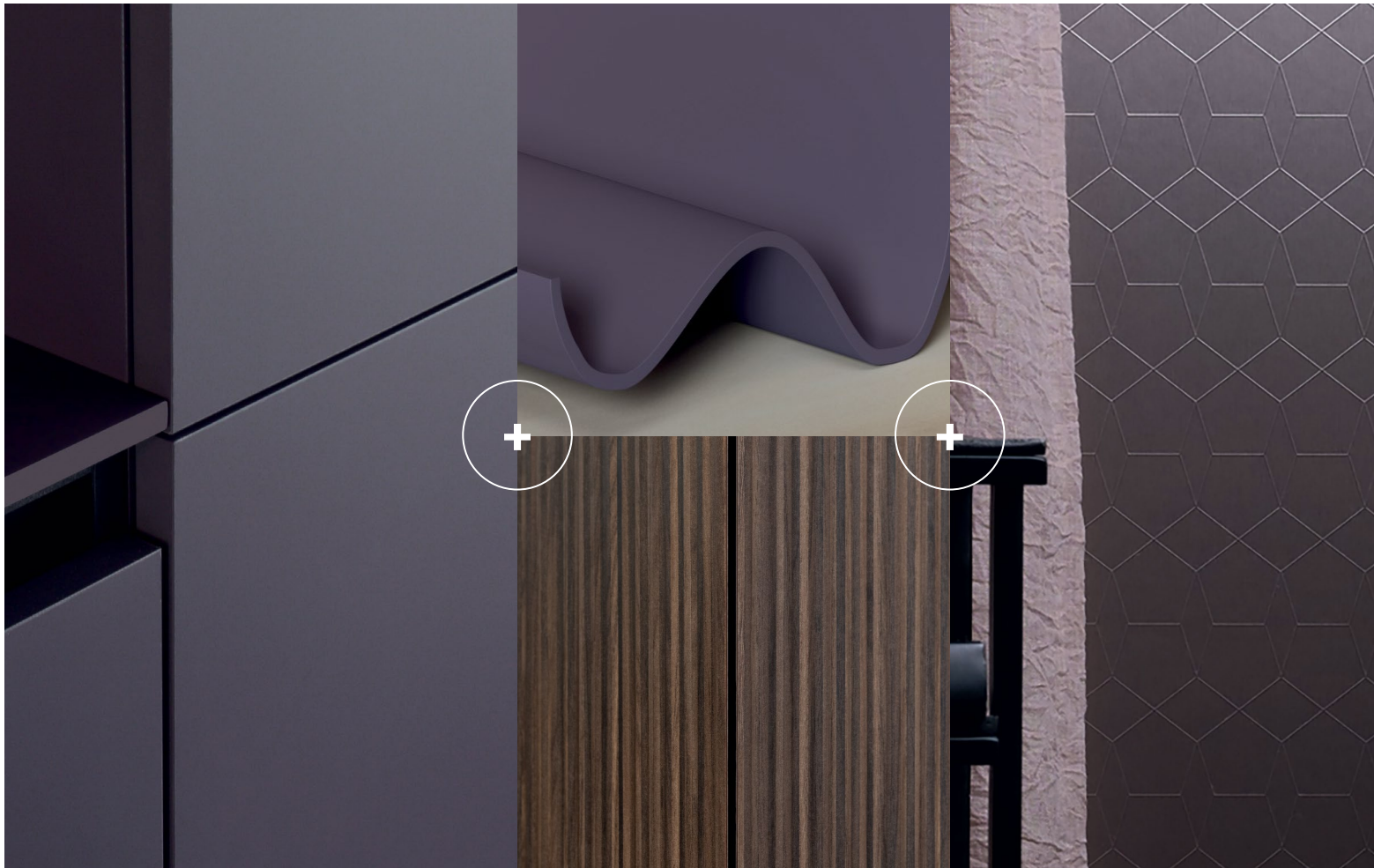

## MORE THAN THE SUM OF THE PARTS. THE BIG +

When you combine materials from different Broadview brands — like Formica, FENIX, Arpa, Homapal, and Getacore — new creative possibilities open up. Unique textures, colors, and finishes come together to create a truly distinctive design.

We call it 'The Big +': a way to mix and match surface materials that helps you elevate your work, differentiate your products, and materialize imagination.

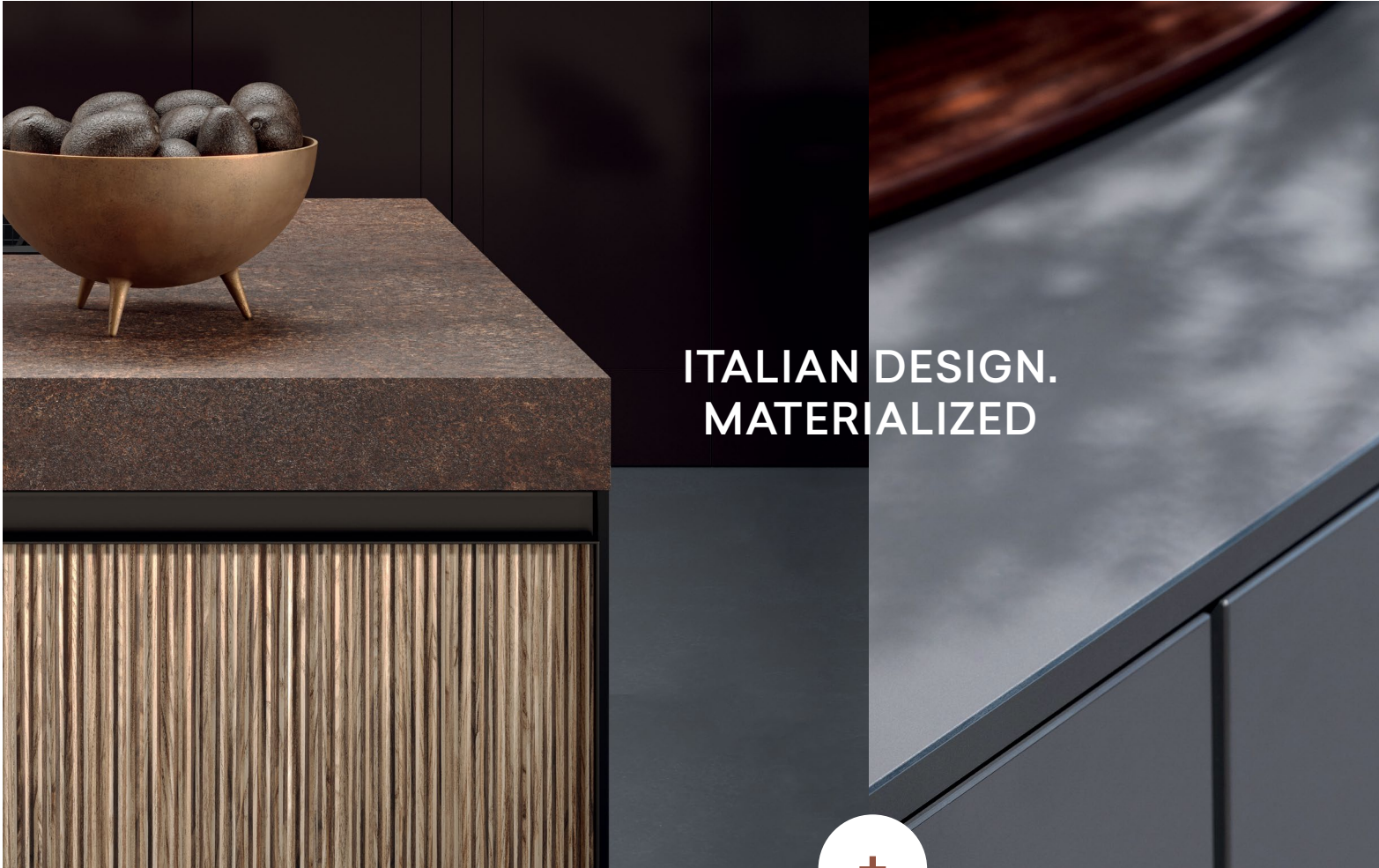

ITALIAN DESIGN.  
MATERIALIZED

ARPA TUET

FENIX

Mix and match Arpa Tuet's deep textures with  
FENIX's timeless matt elegance



Since 1954, Arpa has blended iconic Italian design with material innovation to create high-quality surfaces that elevate interiors. From its roots in Bra, Italy, Arpa collaborates with craftsmen, architects, and kitchen makers to deliver Made-in-Italy solutions. Known for deep textures and sophisticated finishes, Arpa offers a unique visual and tactile experience — bringing refined aesthetics to kitchens, furniture, and commercial spaces.

Discover our portfolio at [arpaindustriale.com](https://arpaindustriale.com)

	TUET		PREMIUM FINISHES		COLOUR MATCHING CORE		VIS	
	ARPA BLOOM							





INNOVATION.  
MATERIALIZED

FENIX

HOMAPAL

Mix and match FENIX's ultra-matt softness with  
Homapal's radiant metal finishes

FENIX®

FENIX brings Italian design and material innovation together in ultra-matt, soft-touch surfaces with anti-fingerprint properties. Thermal healing of superficial micro-scratches is also possible. Thanks to its distinctive technological features and timeless elegance, FENIX provides innovative and aesthetic answers to interior design trends. Loved by architects and users alike, FENIX empowers the creation of elegant kitchens, expressive furniture, and refined interiors that stand out in both form and function.

Discover our portfolio at [fenixforinteriors.com](https://fenixforinteriors.com)

- FENIX  
NTM  
BLOOM
- FENIX NTA
- FENIX  
INTEGRATED  
SOLUTIONS
- X-KIN

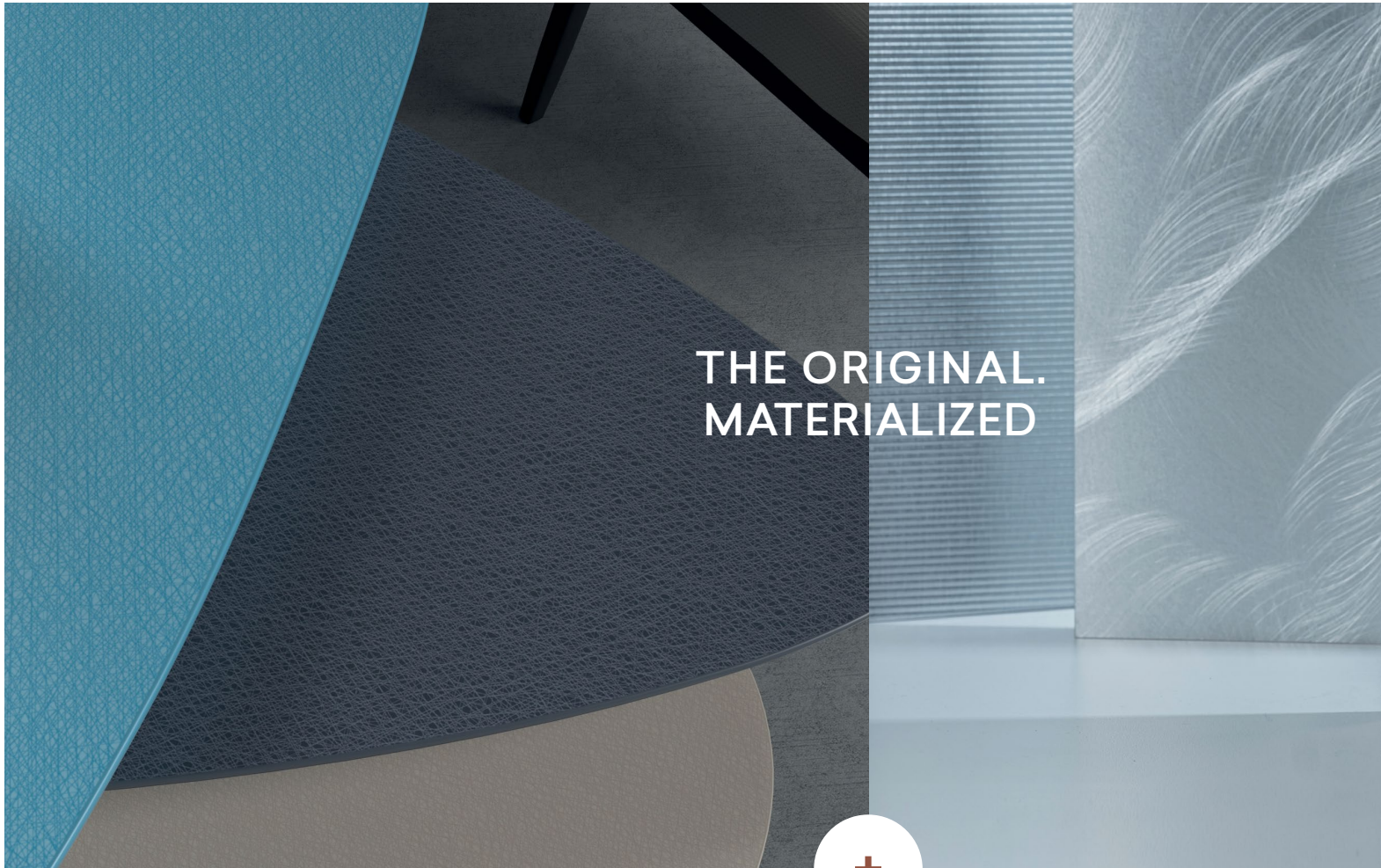

## THE ORIGINAL. MATERIALIZED



**FORMICA**

**HOMAPAL**

Mix and match Formica's iconic color range  
with Homapal's radiant metallic finishes



Formica is more than a material — it's a design revolution that began in 1913. As the original inventor of HPL, Formica has shaped the way we live for over a century. From the post-war home to the contemporary kitchen, from mid-century modern to future-forward design, Formica has been there: expressive, functional, and always evolving.

Crafted primarily from paper, yet endlessly versatile, Formica laminate has become an icon — a medium for creativity, colour, texture and transformation. Designed for everyday excellence, it continues to lead through innovation, inspiring new generations of makers, architects, and interior storytellers.

Discover our portfolio at [formica.com](https://www.formica.com)

| COLORS |

| WOODS |

| PATTERNS |

| COLORCORE |

| YOUNIQUE |



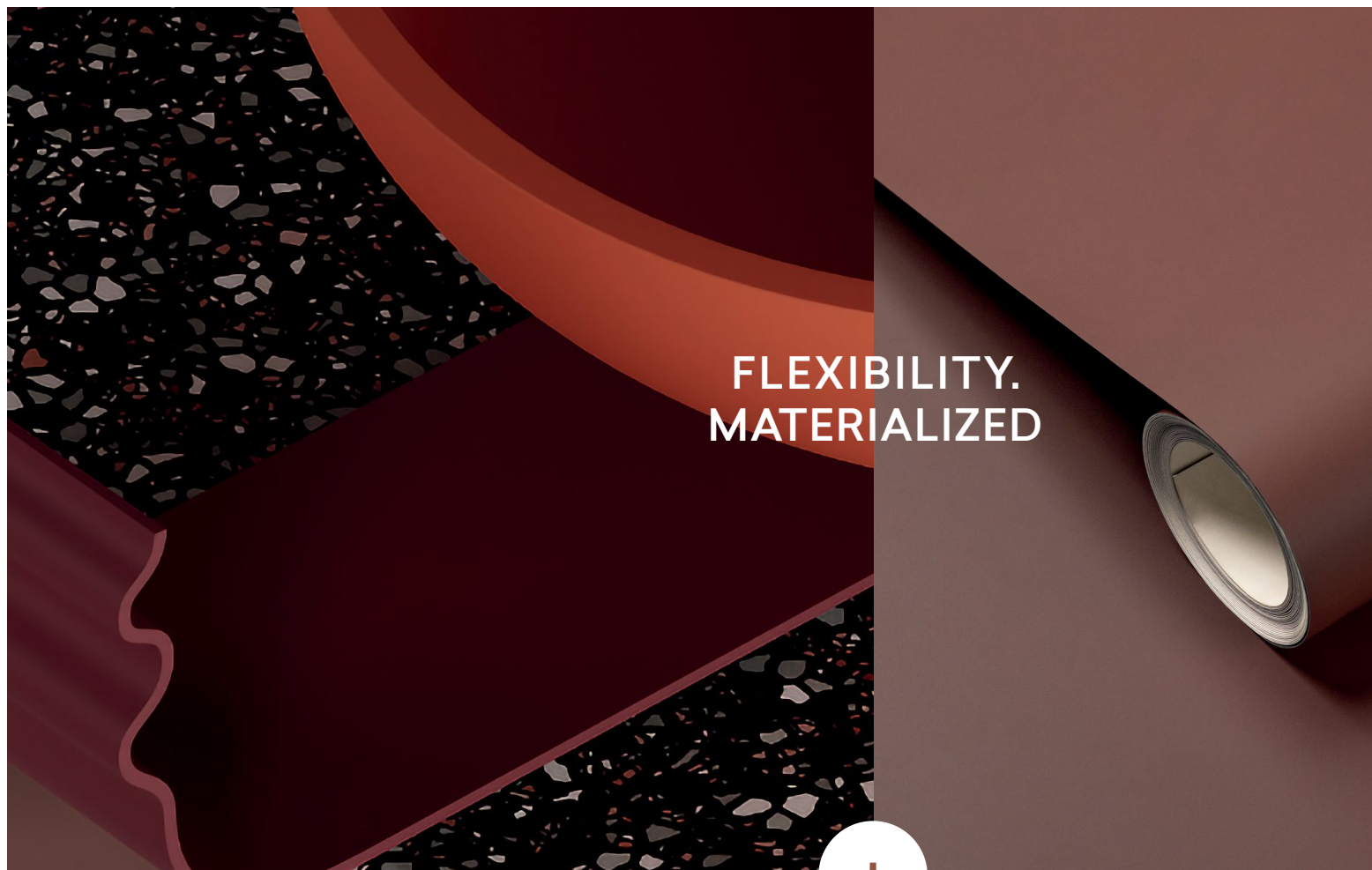

FLEXIBILITY.  
MATERIALIZED



GETACORE

X-KIN BY FENIX

Mix and match Getacore's seamless solid surface  
with X-KIN's tactile wall coverings

## GETACORE®

Getacore opens up new creative possibilities for kitchens, bathrooms, hospitality, and retail interiors. Through the extreme formability of the material and optimal sheet dimensions, we dissolve the limits of design. Manufactured in Germany, this solid surface offers long-term durability, outstanding colour consistency and extraordinary dimensional stability

Whether curved or straight, large or compact, Getacore is designed to shape around your vision. Getacore brings personalised solutions to life — clean, contemporary, and made to last.

Discover our portfolio at [getacore.com](https://getacore.com)

WORKTOPS

SINKS AND  
BASINS

3DEEP

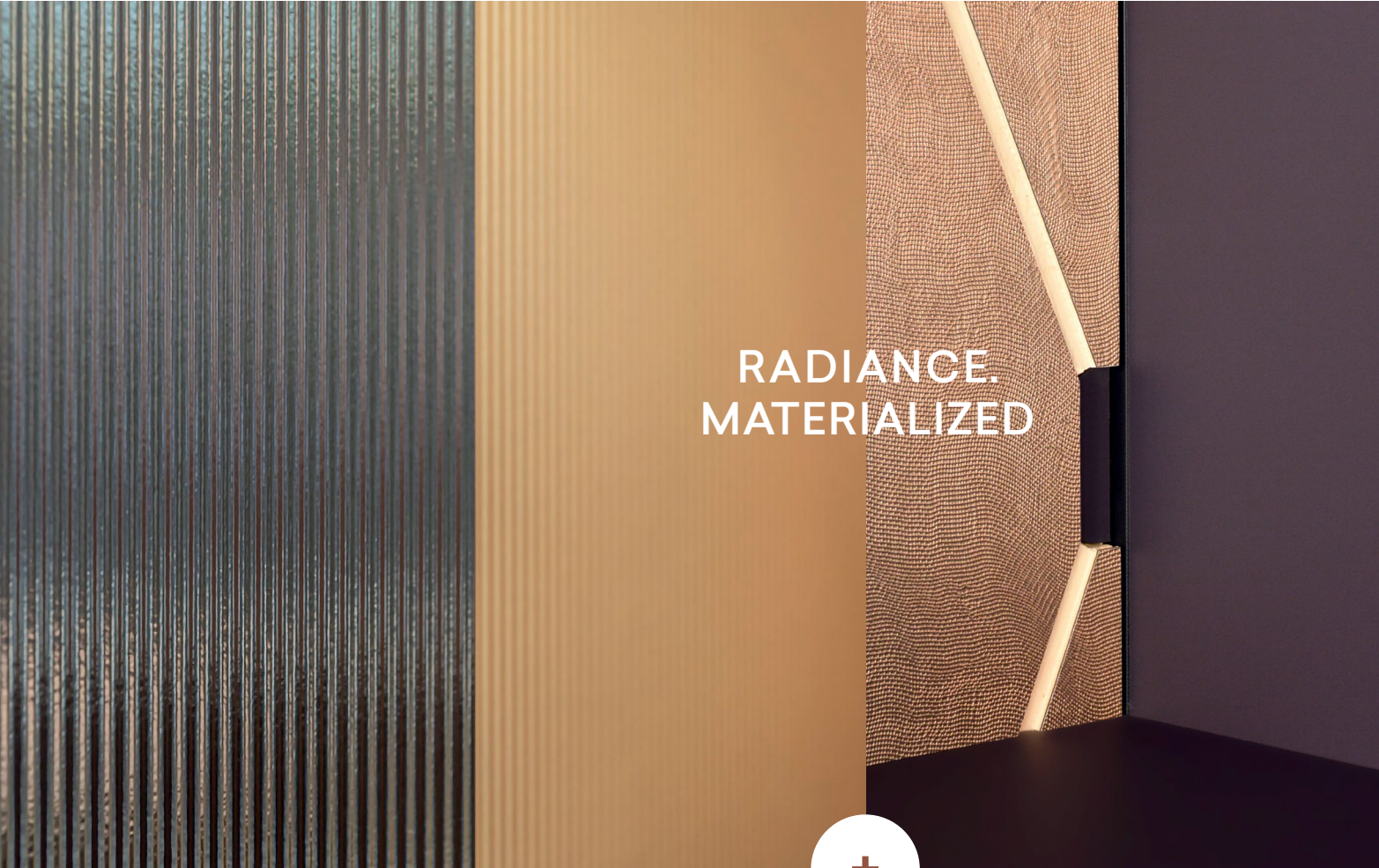

RADIANCE.  
MATERIALIZED

HOMAPAL

FENIX

Mix and match Homapal's radiant metallics  
with FENIX's ultra-matt surfaces



Homapal brings metal to life. Using real aluminium, copper, brass and stainless steel, Homapal laminates add a subtle shine and distinctive texture to interior surfaces. From smooth to structured, the finishes catch the light and create a strong visual impression.

Made in Germany, Homapal stands for reliable quality and refined design. Whether applied to walls, furniture or fixtures, these metal surfaces define the space.

Discover our portfolio at [homapal.com](https://www.homapal.com)

- |                      |                    |                        |   |
|----------------------|--------------------|------------------------|---|
| METALS<br>ELEMENTS   | METALS<br>GESTURES | METALS<br>PERSPECTIVES | METAL<br>SRM SCRATCH<br>RESISTANT<br>MATT |
| MAGNETIC<br>& BOARDS |                    |                        |   |





QUALITY.  
MATERIALIZED



TRESPA

FENIX

Mix and match Trespa's durables exteriors  
with FENIX's elegant interior surfaces

TRESPA®

Trespa transforms architectural vision into lasting impact. Known for pioneering high-performance façade panels, Trespa combines innovation, durability, and refined aesthetics. From ventilated façades to scientific interiors, its materials stand up to time, weather, and wear — while standing out in design. Crafted with natural fibres and advanced technology, Trespa panels bring beauty and resilience in most demanding surfaces.

Discover our portfolio at [trespa.com](https://trespa.com)

METEON

IZEON

PURA

TOPLAB



# CRAFTSMANSHIP. MATERIALIZED

**WESTAG**



**ARPA**

Mix and match Westag's individually finished elements with Arpa's deep Italian textures

**WESTAG**

Rooted in German manufacturing excellence, Westag delivers quality you can see — and feel. From doors and panels to solid surfaces, Westag shapes premium materials for living, working, and building. With decades of know-how, modern production, and a passion for detail, Westag supports makers, architects, and interior professionals with optimized and customized solutions that combine precision, performance, and versatility.

Discover our portfolio at [westag.de](https://westag.de)

- |                 |                      |                     |                               |
|-----------------|----------------------|---------------------|-------------------------------|
| WESTAG<br>TÜREN | SHUTTERING<br>PANELS | VEHICLE<br>PANELS   | INDUSTRIAL<br>FLOORS          |
| WORKTOPS        | WINDOW<br>SILLS      | FURNITURE<br>PANELS | FEELINGS<br>FRONT<br>ELEMENTS |



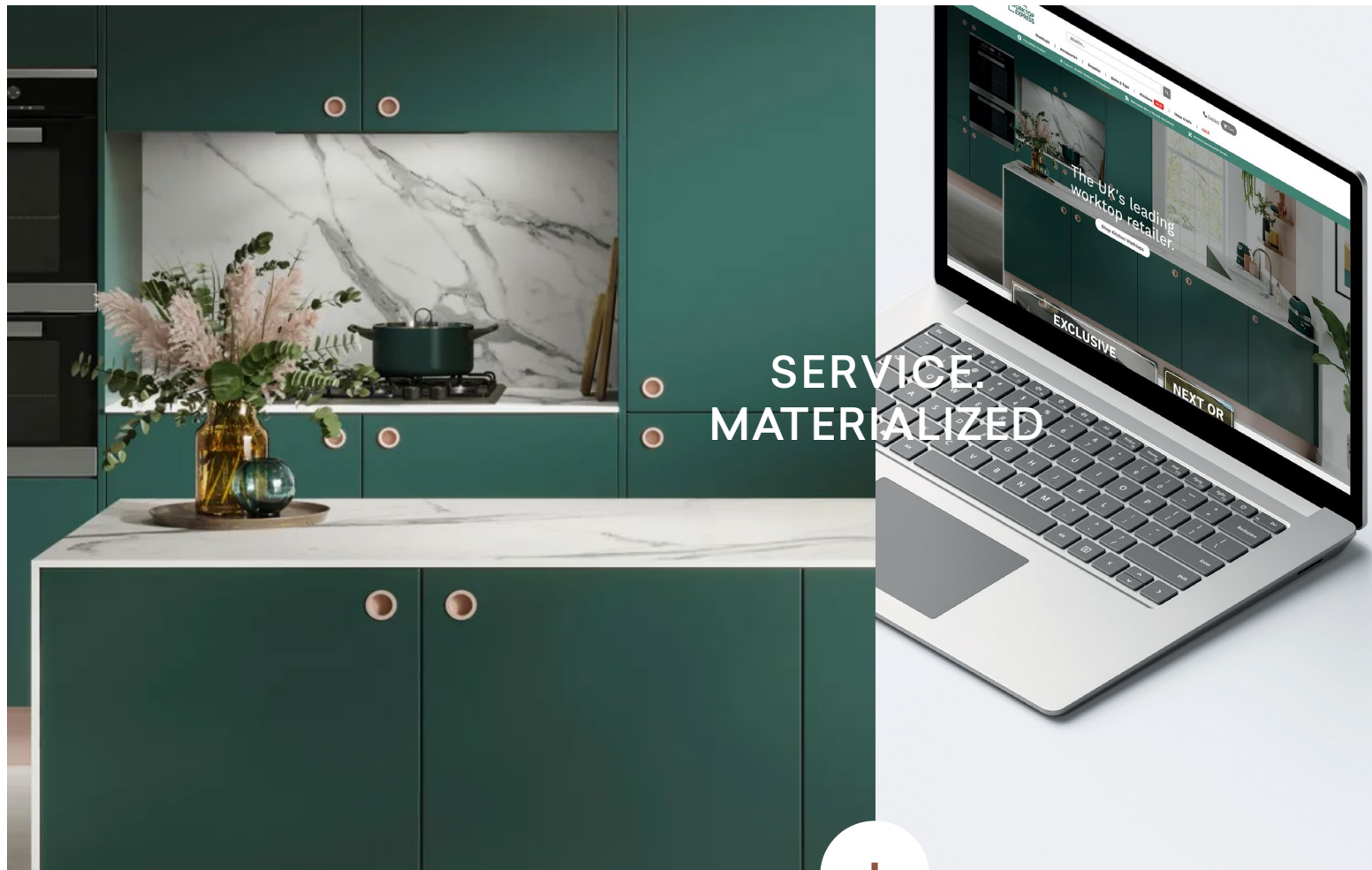

SERVICE  
MATERIALIZED

WORKTOP EXPRESS

BESPOKE

Revolutionary materials, enhanced delivery solutions,  
and expert customization

WORKTOP  
EXPRESS

Worktop Express brings quality and convenience together. With a wide selection of wood, laminate, and solid surface worktops, delivered in UK, fast and cut to size, it's the go-to partner for tradespeople, kitchen makers, and DIYers alike. Online-first and service-driven, Worktop Express combines digital ease with expert craftsmanship – making great design more accessible, every day.

Discover our portfolio at [worktop-express.co.uk](https://worktop-express.co.uk)

WORKTOPS	BESPOKE CUTTING SERVICES	UK NATIONWIDE WITHIN 48 HOURS
----------	--------------------------------	--



NEED SOMETHING NEW? WE LOVE TO MATERIALIZE IT AT OUR GROUP CENTRES OF EXCELLENCE, NEMHO AND MUSA, COMBINING DEEP MATERIAL AND MARKET EXPERTISE

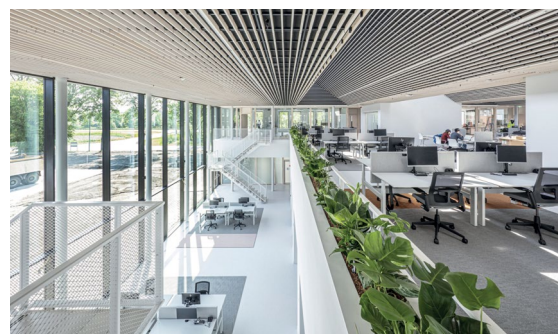

#### NEMHO EXCELLENCE CENTRE OF INNOVATION AND TECHNOLOGY

At Nemho, we turn innovation into practical solutions focusing on research, testing, and product development. We deliver sustainable, high-performance materials that meet industry standards.

[nemho.com](https://nemho.com)

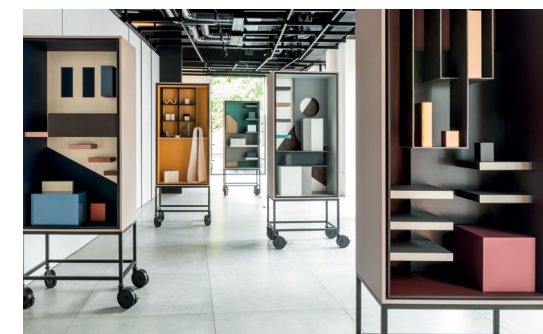

#### MUSA EXCELLENCE CENTRE OF MARKETING, COMMUNICATION AND DESIGN

At Musa, we guide our brands with customer-focused design and marketing. We help create distinctive, market-relevant materials, products, and solutions. When needed, we team up with Nemho to unite design vision and technology — for results that work for you.

[musahub.com](https://musahub.com)



BROADVIEW MATERIALS

6,000 employees

Over 500 own contactpoints

Presence in more than 100 countries

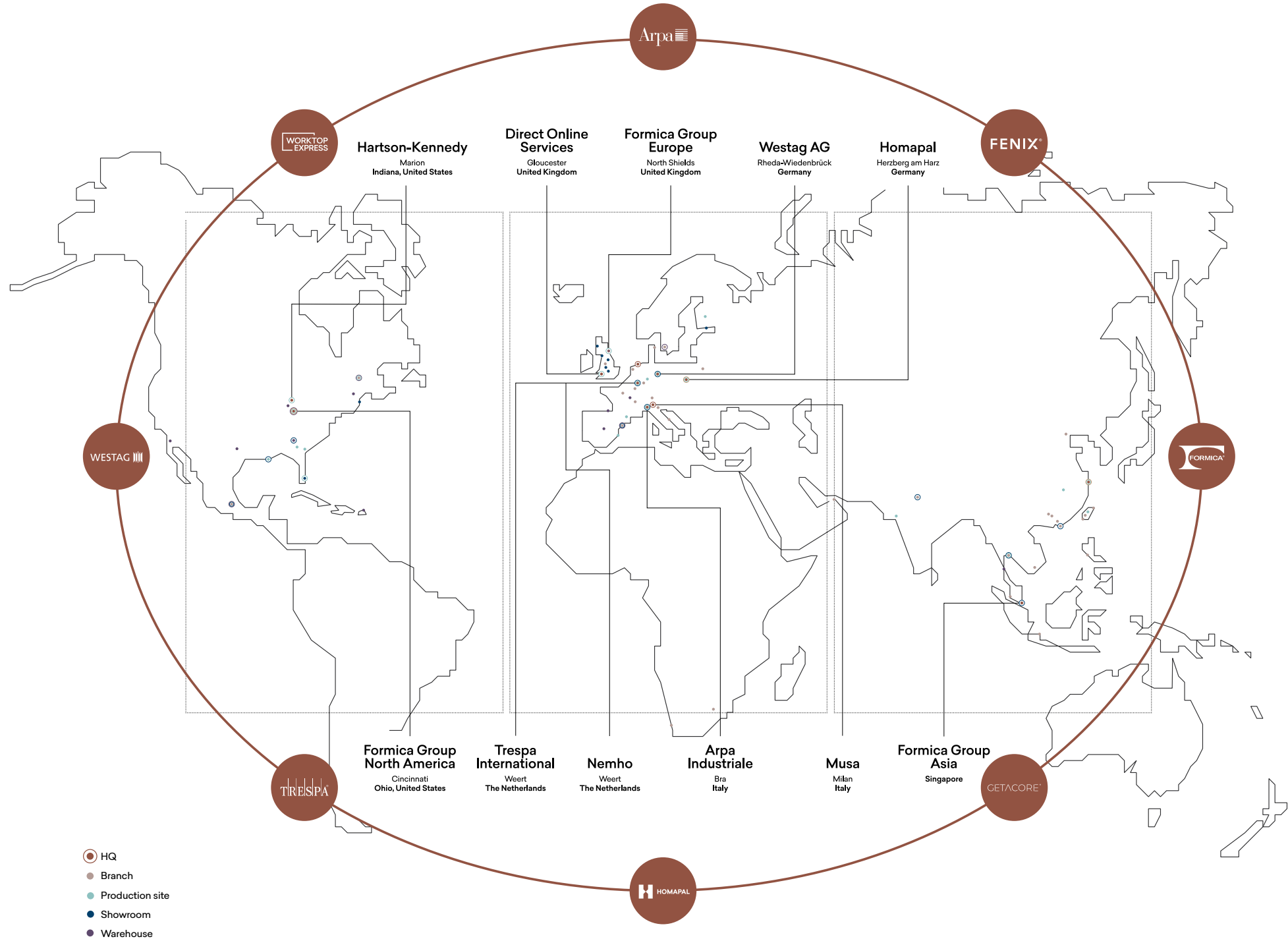



**broadviewmaterials.com**

**Disclaimer  
General**

The information provided by Broadview Materials Group ("Broadview Materials") in this document is solely indicative. The information given in this brochure is correct at the time of publication. However, as we have a policy of constant product development and improvement, product specifications may change in the future. Visit [broadviewmaterials.com](https://broadviewmaterials.com), as the most up-to-date source of information. Broadview Materials does not warrant that the information in this document is suitable for your specific purpose. Colour system notations represent the closest match available in the particular system. They may or may not be exact and are provided for guidance only. When exact colour information is required, please always refer to an actual sample in the specified finish/grade.

**Liability**

Broadview Materials is not liable (neither contractual nor non-contractual) for any damage arising from or related to the use of this document, except if and to the extent that such damage is the result of willful misconduct or gross negligence on the part of Broadview Materials and/or its management. The limitation of liability applies to all parties affiliated with Broadview Materials, including but not limited to its officers, directors, employees, affiliated enterprises, suppliers, distributors, agents, and representatives.

**General Conditions**

All sales of Broadview Material products are governed by the applicable General Terms and Conditions of Sale in effect at the time of sale and contained in every order acknowledgement and are available upon request.

**Intellectual Property**

All intellectual property rights and other rights regarding the content of this document (including logos, marks, text and photographs) are owned by Broadview Materials and/or its licensors.



# BROADVIEW MATERIALS

A WIDE OFFER OF BRANDS, PRODUCTS AND SOLUTIONS